

# RPs' information 6590697

Call out	Part Number	Description	Qty	Material
1	6590658084	TOSS PILLOW SEW KIT	1	Fabric
9	6590697031	CHAISE PAD	1	Fabric
12	427637RP	POLY CUSH	1	FOAM, LMF
17	427640RP	POLY BK CHAISE	1	FOAM, LMF
18	427641RP	POLY OTTO	1	FOAM, LMF
25	6590697281	RAF IN/OUT ARM	1	Fabric
43	6590697021	SEAT PLATFORM	1	Fabric
46	31855P1	259 BLK RND LEG W/NSP 1/P	4	Plastic
52	6590679507	BLACKBOTTOM	1	Fabric
57	6590658384	TOSS PILLOW SACK W/FIBER	1	Fabric, Fiber
102	972MCHPPBMK-2RP	97-2 PWR PBK 29.25 SHORT BLT	1	Metal
145	30953RP	MOTOR PWR PRESSBACK CN-DOER	1	Plastic, Metal
148	30383RP	POWER SUPPLY KIT W/DC CBL-1ST	1	Plastic, Metal
149	76796RP	KD BRACKET AND CLIP ASSEMBLY	2	Metal
165	32055RP3	P2/P3 HEADREST MOTOR PLASTIC MTR SHAFT	1	Plastic, Metal
173	32054RP1	P2 (THR) MECH -14 PLASTIC MTR SHAFT	1	Metal
223	75639RP	CLEVIS PIN .375 X 2	2	Metal
357	30651RP	FIBER RECYCLED BROWN	5	Fiber
400	74843RP	FURNITURE CONNECTOR	2	Metal
419	74018RP	HDWE 1/4-20X.75 WSHRHD5/16	8	Metal

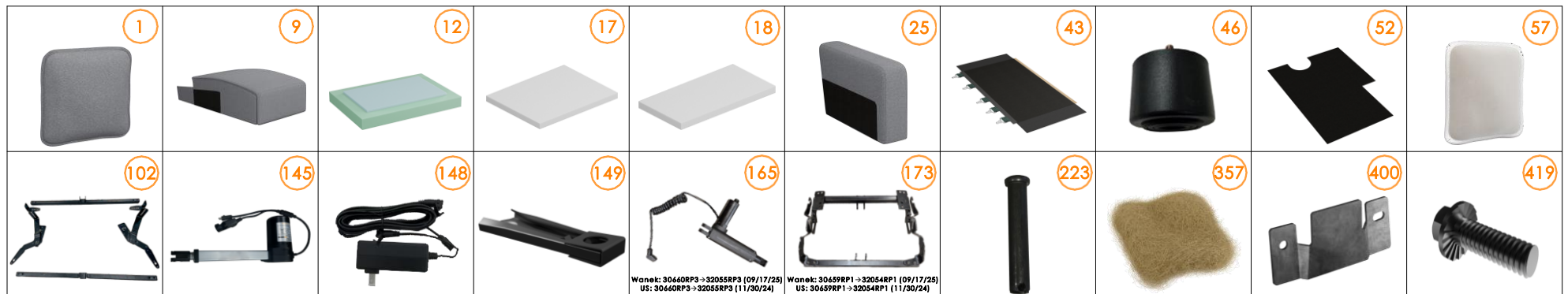

# RPs' information 6590697

Call out	Part Number	Description	Qty	Material
426	77075RP	1-4-20X3/4 HX HD ZINC PRECT80	4	Metal
439	76832RP	POWER ROCKER COTTER 7120700000	2	Metal
479	32477RP	BTN CNTL LSF USB-AC KAIDI RPOL	1	Plastic, Metal
499	73507RP	BOLT 1/4-20X3/4 INCH	4	Metal
547	8001RP	4 X 3/4 FH PHL TAP BLK	4	Metal
34K	6590697048KD	COMPLETE IN/OUT BACK-KD	1	Fabric
653	31865RP	POWER MOTION TESTER CABLE	1	Plastic, Metal
654	32051RP	POWER MOTION TESTER LIGHT	1	Plastic, Metal

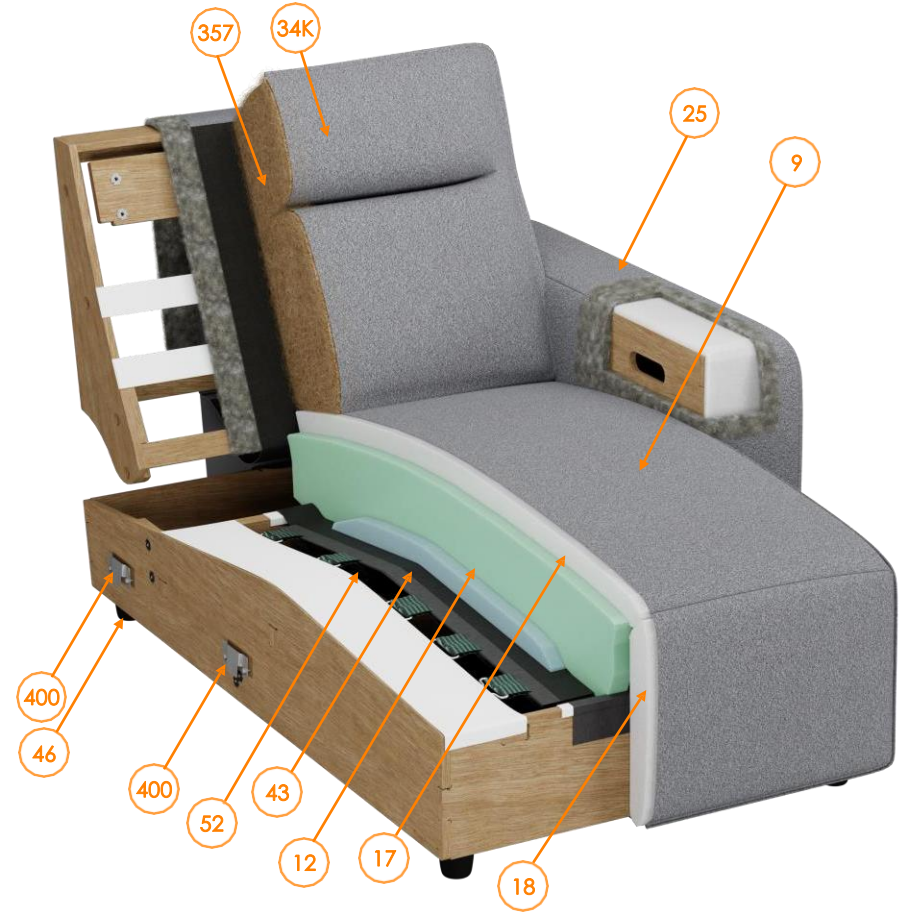

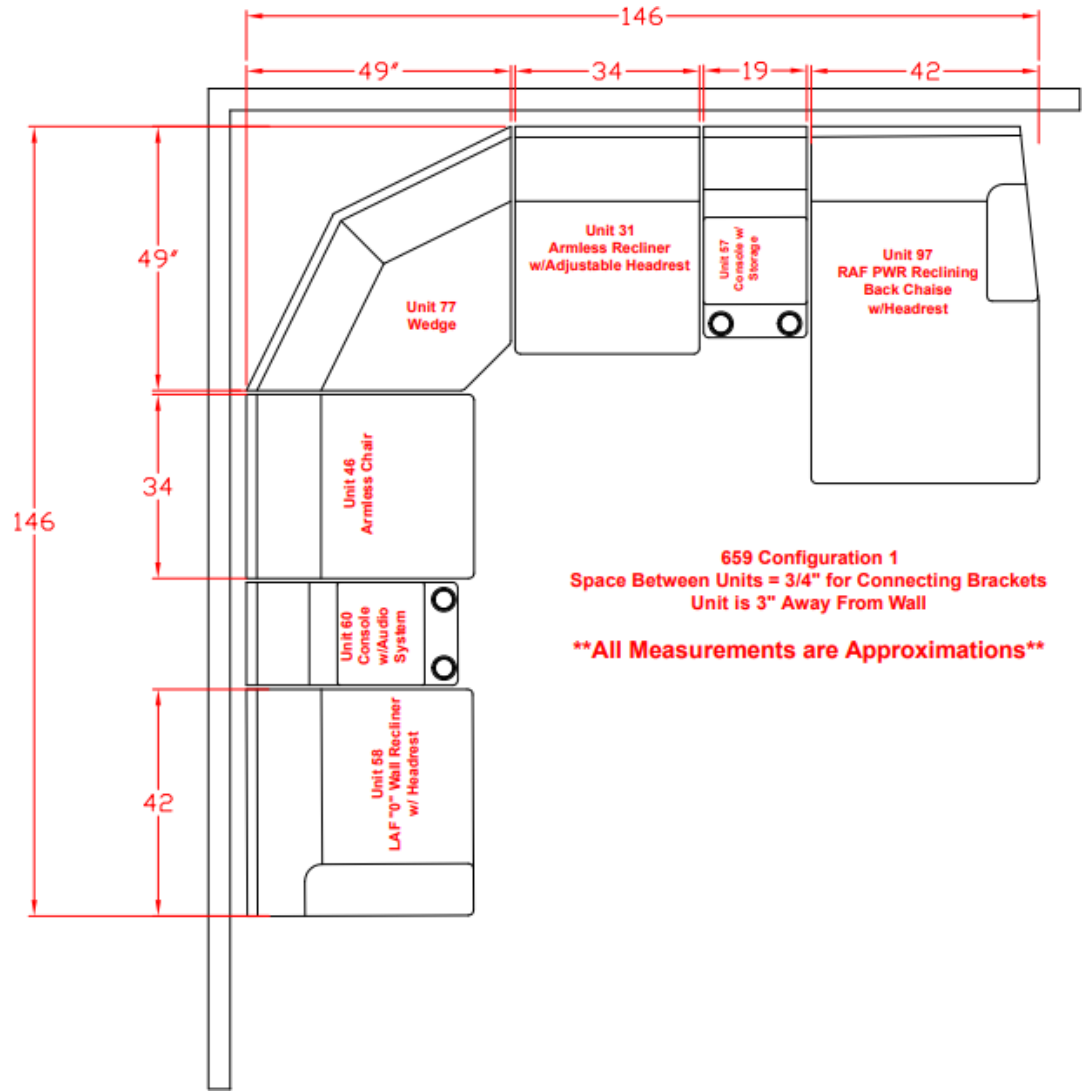

**659 Configuration 1**  
 Space Between Units = 3/4" for Connecting Brackets  
 Unit is 3" Away From Wall

**\*\*All Measurements are Approximations\*\***

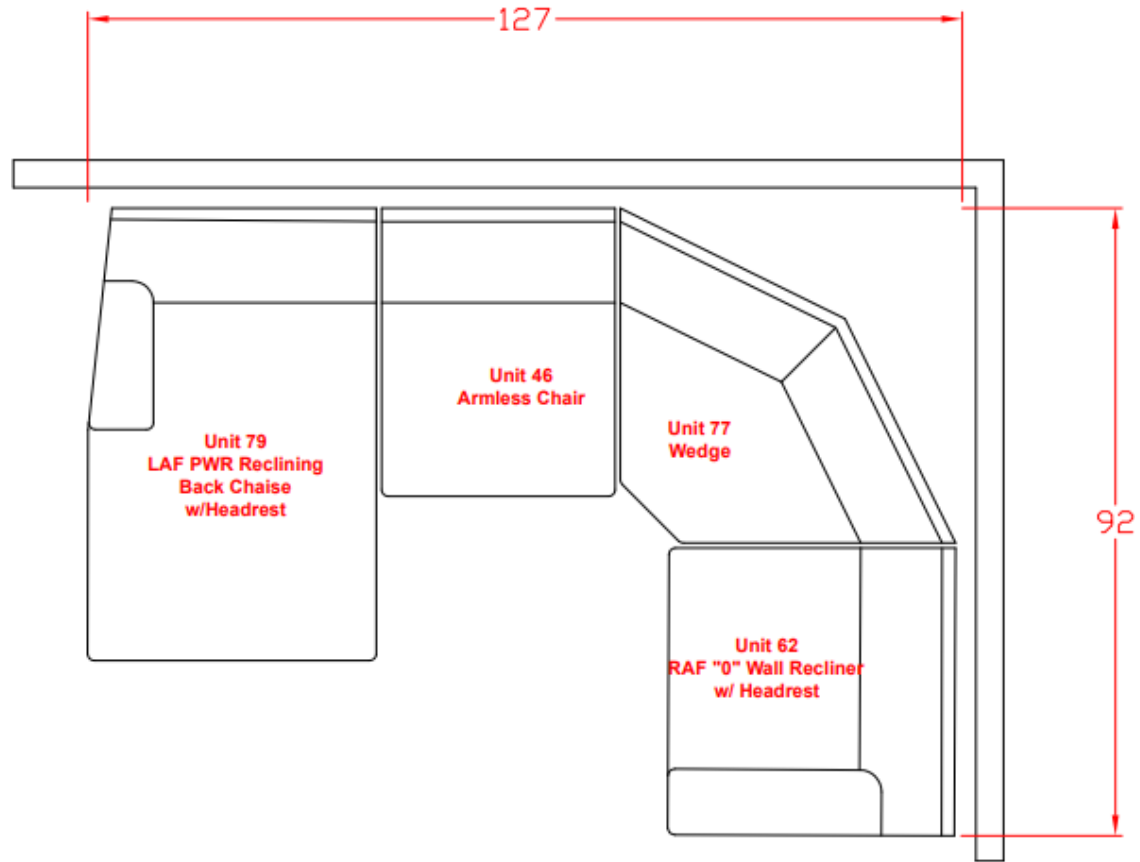

**659 Configuration 2**  
**Space Between Units = 3/4" for Connecting Brackets**  
**Unit is 3" Away From Wall**

**\*\*All Measurements are Approximations\*\***

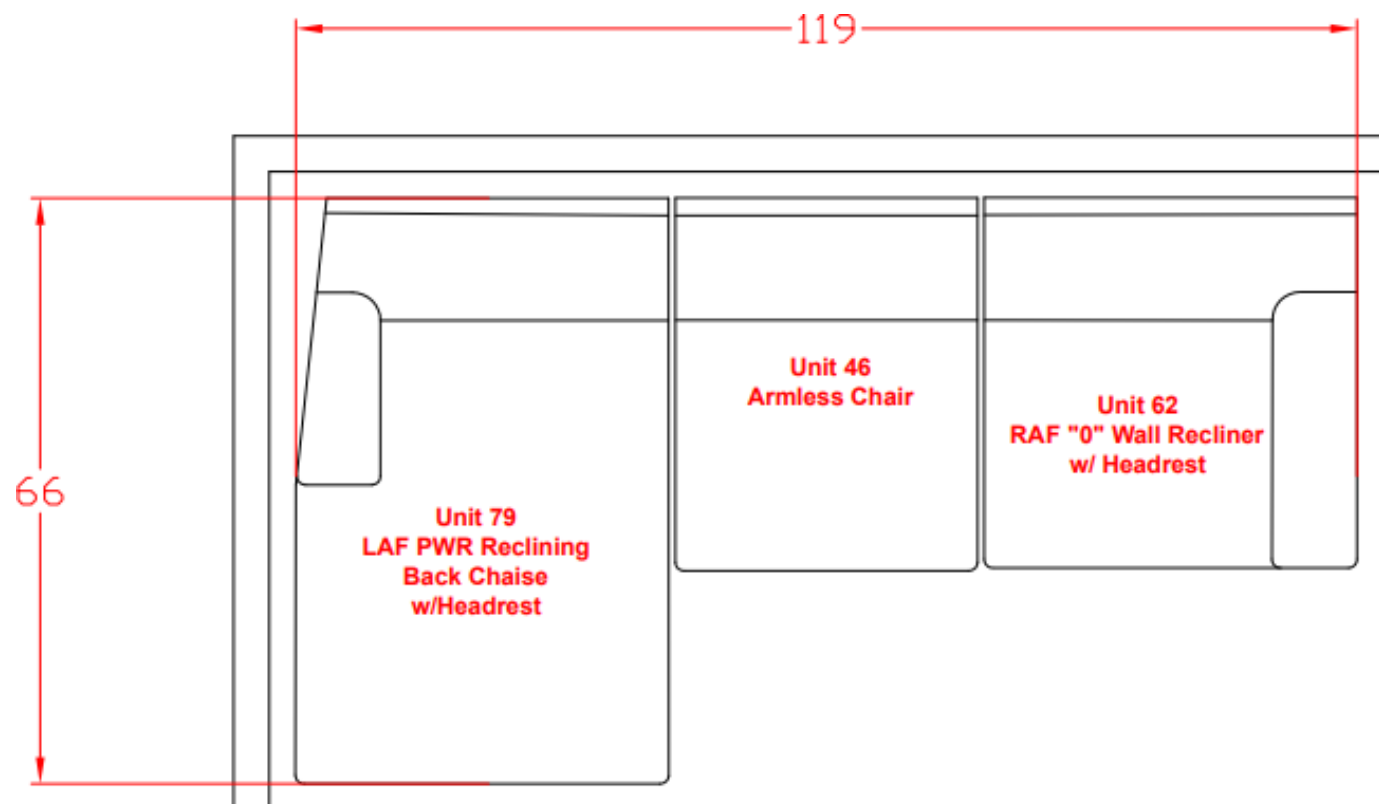

**659 Configuration 3**  
**Space Between Units = 3/4" for Connecting Brackets**  
**Unit is 3" Away From Wall**

**\*\*All Measurements are Approximations\*\***

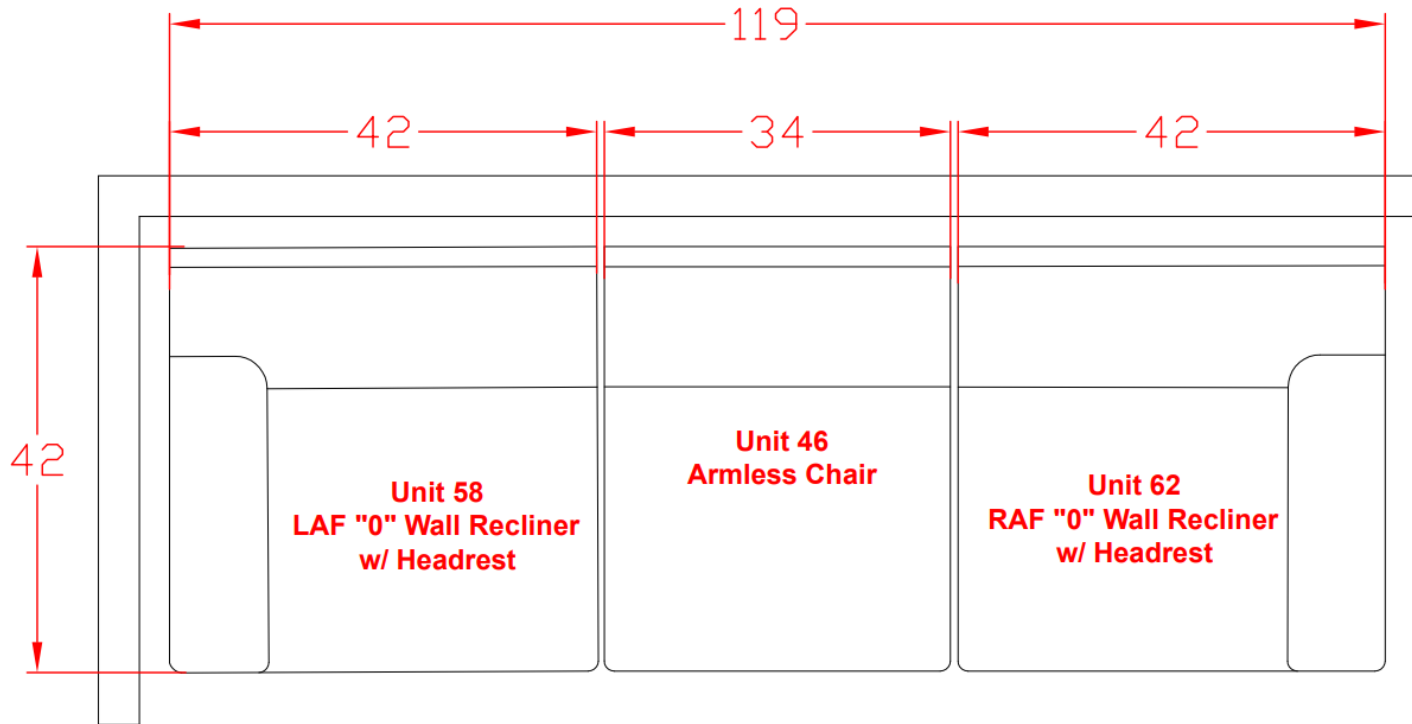

**659 Configuration 4**  
**Space Between Units = 3/4" for Connecting Brackets**  
**Unit is 3" Away From Wall**

**\*\*All Measurements are Approximations\*\***